

REVISIONS		
SYM	DESCRIPTIONS	DATE

SCHEDULE OF EQUIPMENT

1 - POWER WALL EXHAUST VENTILATOR: 1 ea.

- CENTRIFUGAL FAN TYPE, DIRECT DRIVEN WITH SPUN ALUMINUM HOUSING & WHEEL, WEATHER-PROOF, W/ VIBRATION ISOLATORS. NOMINAL CAPACITY OF 1,550 CFM AT 1/2" WG. STATIC PRESSURE.
- ELECTRIC MOTOR: 1/4 HP, 115 VOLTS, 1 PHASE, 60 HZ. RESPIRED & RATED PERFORMANCE DATA SHALL BE IN ACCORDANCE WITH AMCA 210 AND SHALL BEAR AMCA SEAL.
- MADE BY AIRMASTER FAN CO., MODEL AVDC 1500V OR EQUIVALENT.

- GENERAL NOTES:**
1. VERIFY THE EXISTING FIELD CONDITIONS BEFORE TO START OF WORK OR FABRICATION OF MATERIALS.
 2. COORDINATE WITH ACTIVITY SCHEDULE AND USING AGENCY FOR THE ACCESS IN THE FACILITY AND DOWNTIME OF VENTILATION SYSTEM.
 3. PERFORM THE WORK IN SUCH A MANNER TO PREVENT DAMAGE OF EXIST. EQUIP. AND OTHER APPURTENANCE.
 4. ALL VENTILATION EQUIPMENT/MATERIAL, INSTALLATION SHALL BE IN ACCORDANCE WITH ASHRAE CRITERIA AND SMACNA STANDARD FABRICATION/CONSTRUCTION WORK.
 5. PERFORM OPERATIONAL TEST AFTER INSTALLATION OF NEW VENTILATION SYSTEM, AND BALANCE THE SYSTEM AS PER CFM INDICATED.
 6. RESTORE ALL DISTURBED AREAS TO ORIGINAL CONDITION.
 7. ALL ELECTRICAL MATERIALS AND WORKMANSHIP SHALL BE IN ACCORDANCE WITH APPLICABLE SECTIONS OF THE LATEST EDITION OF NATIONAL ELECTRICAL CODE (NEC).
 8. METALLIC ENCLOSURES, RACEWAYS AND ELECTRICAL EQUIPMENT SHALL BE GROUNDED IN ACCORDANCE WITH REQUIREMENTS OF NEC ARTICLE 250. PROVIDE GROUND WIRE IN EVERY RACEWAY.
 9. NEW WIRING SHALL BE NEC TYPE THW OR THHN, 600 VOLTS, CONDUCTORS SHALL BE COPPERS.
 10. NEW MANUAL STARTER SHALL BE FULL VOLTAGE STARTER, PASSE OPERATED TYPE SWITCH WITH PLOT LIGHT, 120V, NEMA 1 ENCL.

- LEGEND/ABBREVIATIONS**
- NEW
 - EXISTING
 - ← AIR REGISTER W/ VOLUME CONTROL
 - ⊥ AIR VOLUME DAMPER
 - P.O.C. POINT OF CONNECTION
 - O.C. ON CENTER
 - OBD - OPPOSED BLADE DAMPER

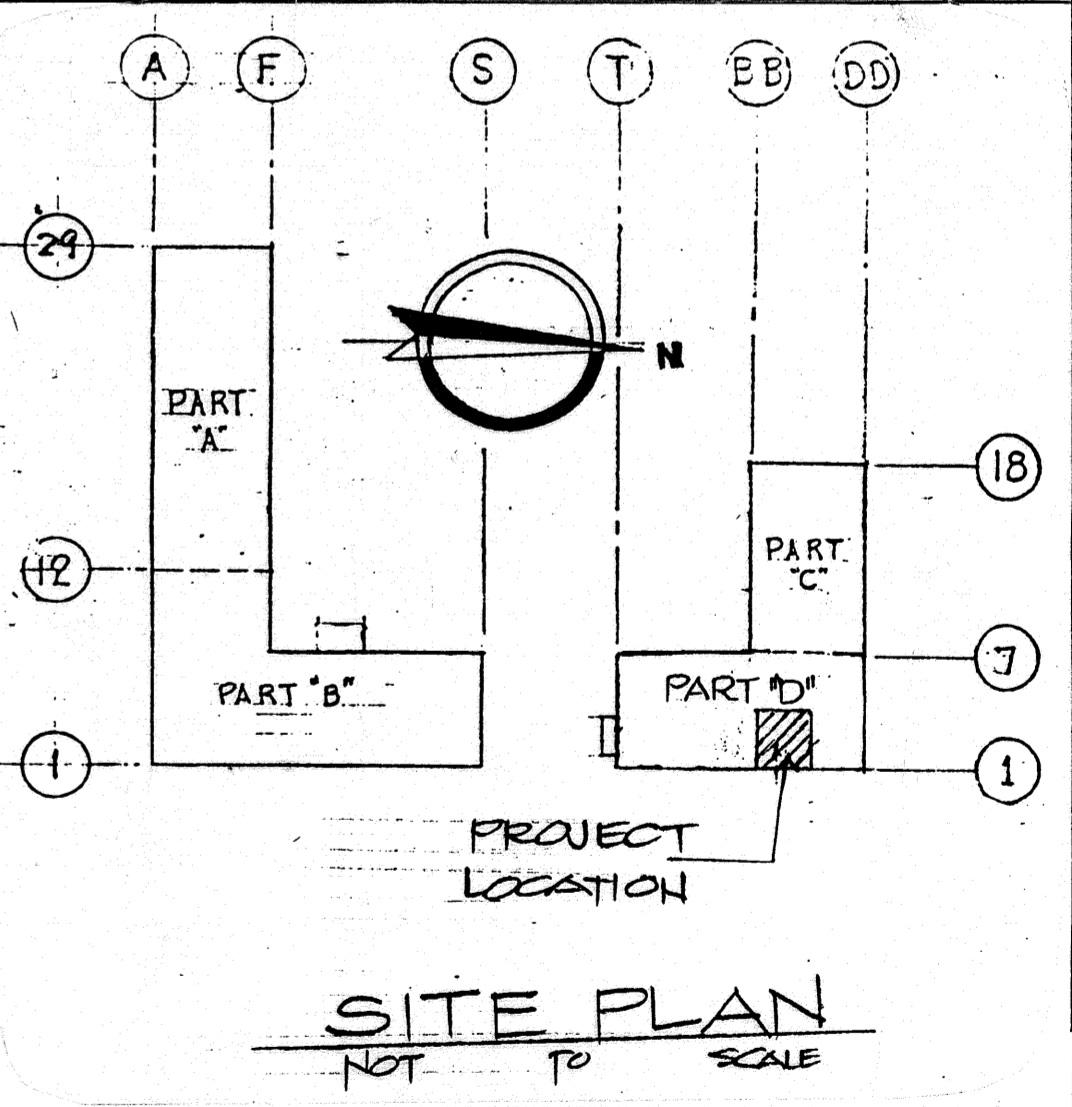

REVIEWED FOR CONSTRUCTIBILITY BY: M. J. Marnell DATE: 4/18/72 INDUSTRIAL HYGIENE DATE: 4/18/72	PDE SPV EIC BR. MGR. R. B. B. / P. B. B. DIV DIR DEPT HEAD SCE WR NO 50179	DEPARTMENT OF THE NAVY NAVAL FACILITIES ENGINEERING COMMAND PUBLIC WORKS CENTER GUAM, M.I. U.S. NAVSHIPREPAC REPLACE HEAD EXHAUST SYSTEM SHOPS 17/72, BLDG. 21 PARTIAL FLOOR PLAN - BLDG. 21, SECTION & DETAILS SCHEDULE OF EQUIP., GEN. NOTES, SITE PLAN
SATISFACTORY TO: M. J. Marnell DATE: 4/18/72 INDUSTRIAL HYGIENE DATE: 4/18/72	APPROVED DATE APPROVED DATE	CODE IDENT NO 80091 SIZE D PWC DRAWING NO. 17549 SCALE SPEC
SATISFACTORY TO: C. J. Hoff DATE: 4-17-72 SAFETY MGR. G. B. G. DATE	APPROVED DATE	SHEET 1 OF 1